



**14c Liverpool Road, Preston, PR1 0AD**

**£149,950**

Situated in the heart of Penwortham, this spacious 1st floor property features planing in place for conversion to 3 offices. This is a unique opportunity to acquire sought after space in the highly desirable village of Penwortham

The property features 3 separate offices spaces, a well-maintained communal bathroom, and a separate kitchen. The property features a private stair case and front door, accessed just off Priory Lane. There is allocated parking for 1 vehicle with street parking available near by. The property is in good condition throughout and is offered with no chain.

Located on Liverpool Road, you'll enjoy easy access to local amenities, eateries, and transport links. This type of property is very rare, offering exceptional value in the incredibly popular location of Higher Penwortham. If you have any questions or would like to arrange a viewing, please get in touch.

Floor Plan

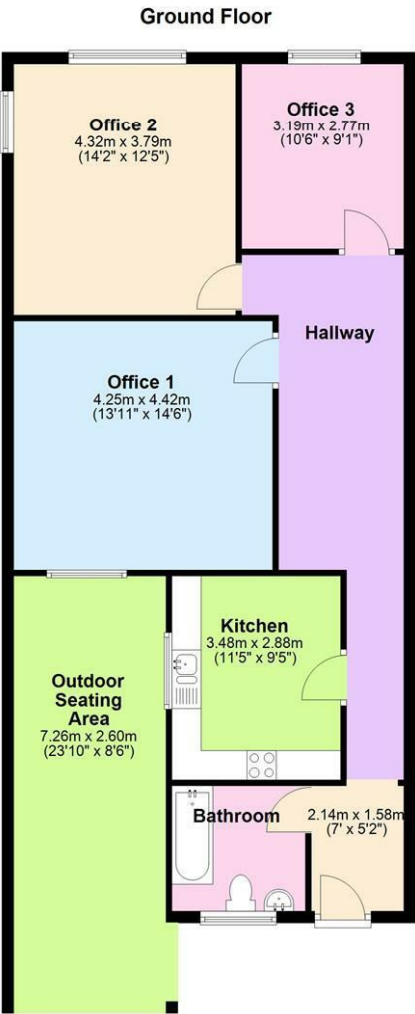

Area Map

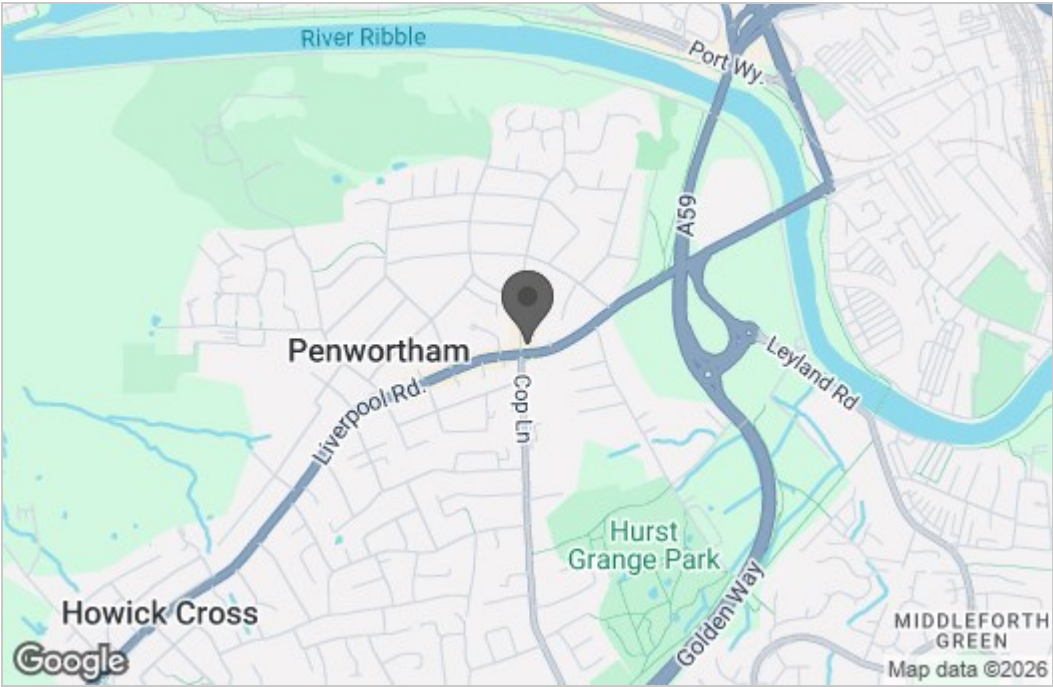

Energy Efficiency Graph

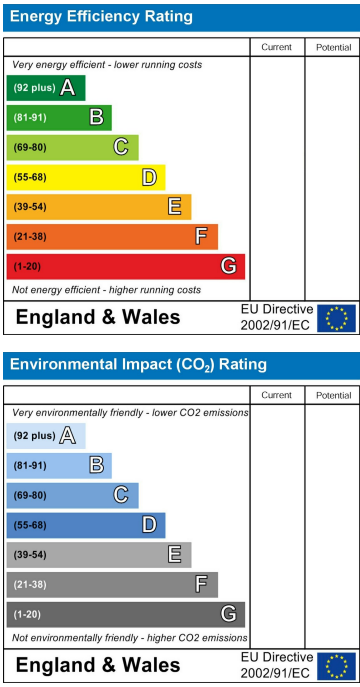

These particulars, whilst believed to be accurate are set out as a general outline only for guidance and do not constitute any part of an offer or contract. Intending purchasers should not rely on them as statements of representation of fact, but must satisfy themselves by inspection or otherwise as to their accuracy. No person in this firms employment has the authority to make or give any representation or warranty in respect of the property.